

**SPECIFICATIONS:**

- CAN BE ASSEMBLED ON 2-WAY AND 3-WAY VALVE BODIES IN REGULATING (1, 3, 6RPM) OR SHUTOFF CONFIGURATION
- INTEGRATED DEUTSCH 4-PIN DT04 CONNECTOR
- BALL POSITION CAN BE CONTROLLED IN 1° INCREMENTS FOR PRECISE CONTROL
- INTEGRATED ELECTRONICS CAN PROVIDE FEEDBACK AND DIAGNOSTICS TO THE CONTROLLER
- CAN BUS CABLING SAVES INSTALLATION TIME AND WEIGHT WHEN CONNECTING MULTIPLE VALVES TOGETHER
- CAN BUS VALVES USE ISOBUS AND J1939 COMPATIBLE MESSAGES
- CAN BUS ALLOCATION IS DONE BY THE VALVE'S SERIAL NUMBER WHICH IS PRINTED ON MOTOR ENCLOSURE
- DATA TRANSFERRED AT 250 Kbit/SEC
- FOR TEEJET CAN BUS PROTOCOL PLEASE CONTACT YOUR TEEJET REPRESENTATIVE OR TEEJET TECHNICAL SUPPORT

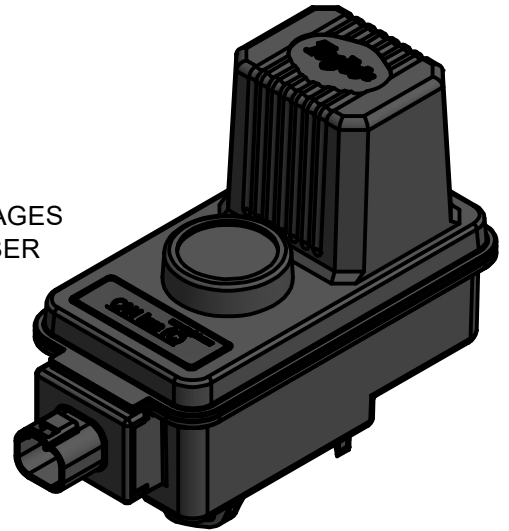

**FEATURES INCLUDE:**

- MOTOR IS SEALED AND WELDED TO IP67
- QUICK RELEASE MOTOR HEAD ALLOWS MANUAL VALVE OPERATION
- GEARBOX USES DOUBLE WALL CONSTRUCTION TO ADD STRENGTH AND ENSURE PERMANENT LUBRICATION
- ALL METAL GEARS FOR STRENGTH AND DURABILITY

**ORDERING INFORMATION:**

- MOTOR CAN BE ASSEMBLED ON ALL EXISTING 344/364 AND 346/366 STYLE VALVE BODIES
- SEE DATA SHEET DS344C FOR COMPLETE ORDERING INFORMATION
- SAMPLE PART NUMBERS:

344C-2F-06Q - 2-WAY, 50 SERIES FLANGE INLETS, 6RPM MOTOR WITH DEUTSCH CONNECTION

B346C-36-03Q - 3-WAY, 1-1/2" BSPT THREAD INLETS, 3RPM MOTOR WITH DEUTSCH CONNECTION

**CONNECTION DETAIL:**

WIRING CHART	
PIN	CONNECTION
1	+12VDC
2	GROUND
3	CAN H
4	CAN L

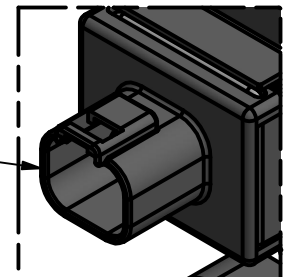
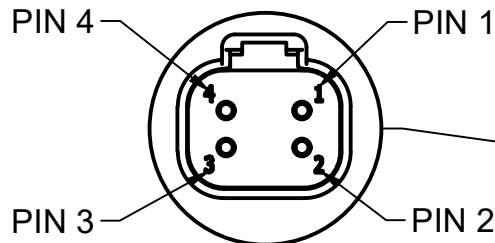

**DESCRIPTION:**

**118588 CAN BUS  
ELECTRIC MOTOR**



REVISION NO.

1

REFERENCE:

2/22/24

Data Sheet No.

**DS118588**

SHEET:

1 OF 1

DWG SIZE:

A